

SUBDIVISION PLAT OF
UNIT IV
LAKE ADVENTURE
 RECREATION VEHICLE COMMUNITY
 LAKE ADVENTURE INC. OWNER & DEVELOPER
 BOX 225 GOULDSBORO, PA. 18424
DINGMAN TOWNSHIP, PIKE COUNTY, PA.

REVISED: _____
 / 30 / 78
 / 20 / 79
 / 9 / 79

DRAWN BY: R. L. STEM
 CHECKED BY: J. R. ROGERS

DATE: MARCH 8, 1976
 ROBERT E. FELKER, INC. 1101 N. 5th ST. STROUDSBURG, PA.

100' 0' 100' 200'
 SCALE

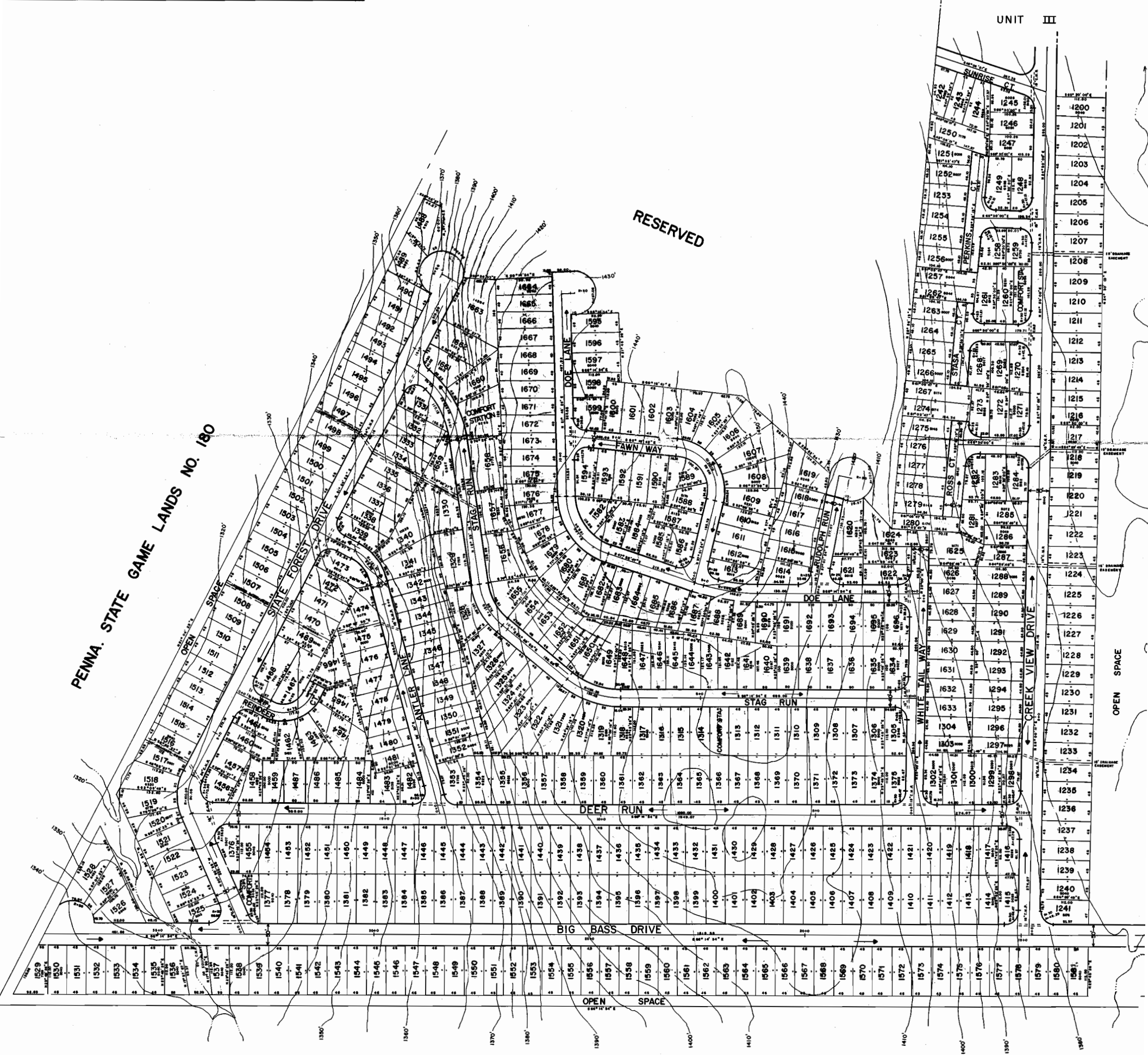

PENNA. STATE GAME LANDS NO. 180